



- Notes**
1. If this drawing has been issued electronically, it is the recipient's responsibility to print the drawing to the correct scale.
 2. All dimensions in metres unless stated otherwise. DO NOT scale from this drawing, use written dimensions ONLY. Where additional information is required please contact the Engineer.
 3. All discrepancies are to be reported to the Engineer.

- Key**
- Resurfacing of carriageway in bituminous material
 - Replacement of road hump in bituminous material
 - Lay-by in block paving blocks
 - NOT TO BE REMOVED

This map is reproduced from Ordnance Survey material with the permission of Ordnance Survey on behalf of the Controller of Her Majesty's Stationery Office. Crown copyright and database rights 2024. OS Licence 100032228. You are granted a non-exclusive, royalty free, revocable licence solely to view the Licensed Data for non-commercial purposes for the period during which Nottingham City Council makes it available. You are not permitted to copy, sub-license, distribute, sell or otherwise make available the Licensed Data to third parties in any form. Third party rights to enforce the terms of this licence shall be reserved to OS.



Rev.	Date	Details	By



Resident Services | Highway Services
Humber Building | Eastcroft Depot | London Road | NG2 3AH

Scheme
LTP 2024/25 Planned Carriageway Maintenance
Carriageway Surfacing
Title
Conway Close, St Anns Ward
General Layout

Drawn	Checked	Authorised
SC	MM	BB
Scale (printed @ A1) NTS		Date 15/07/2024

Purpose of drawing
CONSTRUCTION

Drawing Number	Revision
HD/P24001/CONWA/100/001	

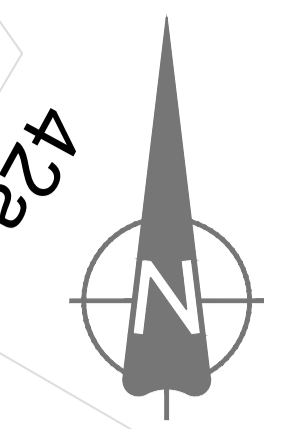
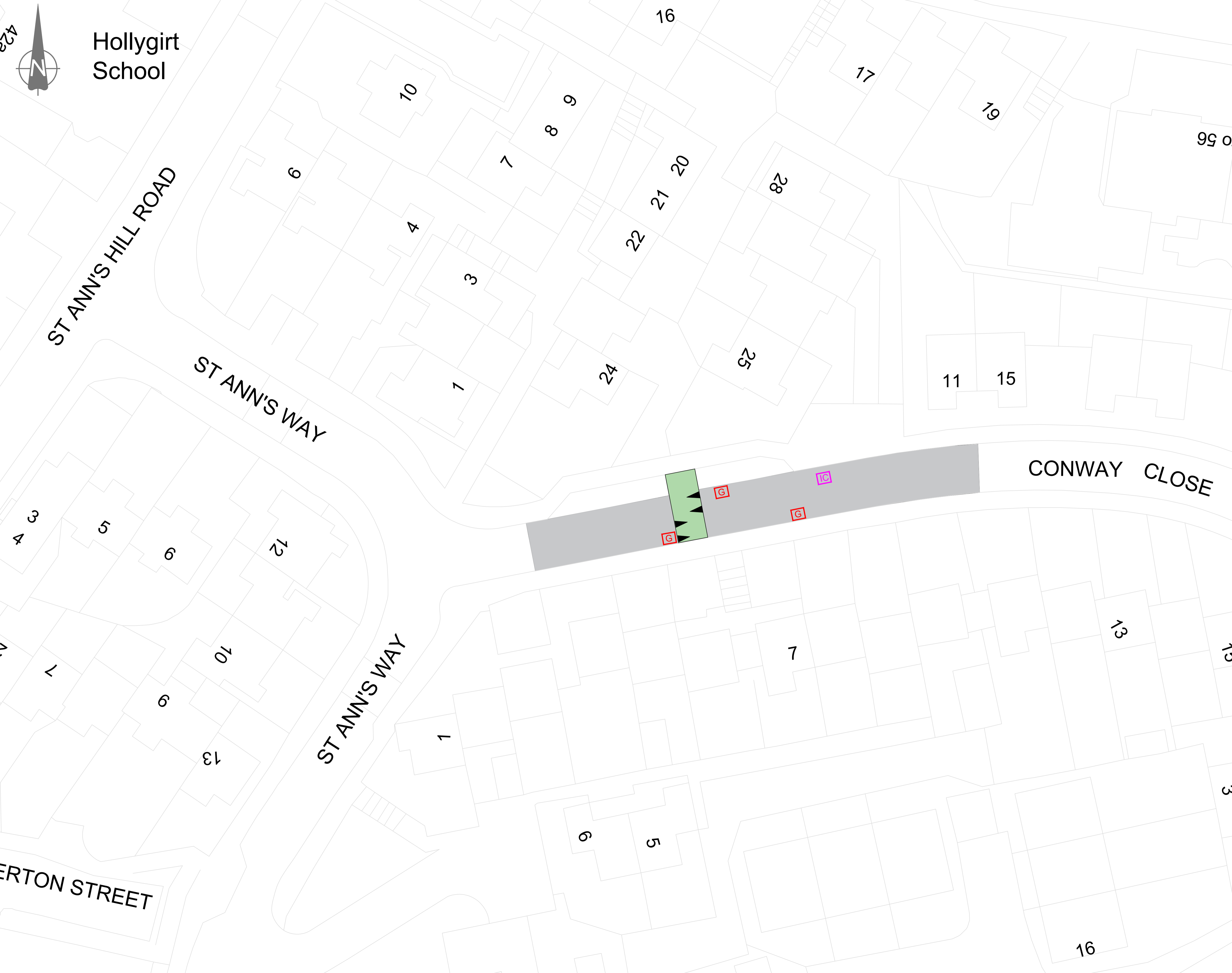

Hollygirt School

- Notes**
1. If this drawing has been issued electronically, it is the recipient's responsibility to print the drawing to the correct scale.
 2. All dimensions in metres unless stated otherwise. DO NOT scale from this drawing, use written dimensions ONLY. Where additional information is required please contact the Engineer.
 3. All discrepancies are to be reported to the Engineer.
 4. Temporary traffic management to be in accordance with Chapter 8
 5. Pedestrian routes to remain available at all times

- Key**
- Remove & replace 3no. gully, cover and frames in carriageway.
 - Remove & replace 1no. inspection chamber cover and frames in carriageway.
 - Plain off existing road hump / reinstate with round top hump from kerb side to kerb side approx. 28 Sq.m in area
 - Extent of surfacing approx. 280 Sq.m in area

This map is reproduced from Ordnance Survey material with the permission of Ordnance Survey on behalf of the Controller of the Map. © Crown copyright and database rights 2024. All rights reserved. No part of this publication may be reproduced, stored in a retrieval system, or transmitted in any form or by any means, electronic, mechanical, photocopying, recording, or otherwise, without the prior written permission of Ordnance Survey. This permission does not extend to other maps or data available from Ordnance Survey. Ordnance Survey is not responsible for any errors or omissions in this publication. Ordnance Survey is not liable for any loss or damage arising from the use of this publication.

Rev.	Date	Details	By

Resident Services | Highway Services
Humber Building | Eastcroft Depot | London Road | NG2 3AH

Scheme
LTP 2024/25 Planned Carriageway Maintenance
Carriageway Surfacing

Title
Conway Close, St Anns Ward
Site Clearance

Drawn	Checked	Authorised
SC	MM	BB
Scale (printed @ A1)	Date	
NTS	15/07/2024	

Purpose of drawing
CONSTRUCTION

Drawing Number	Revision
HD/P24001/CONWA/200/001	

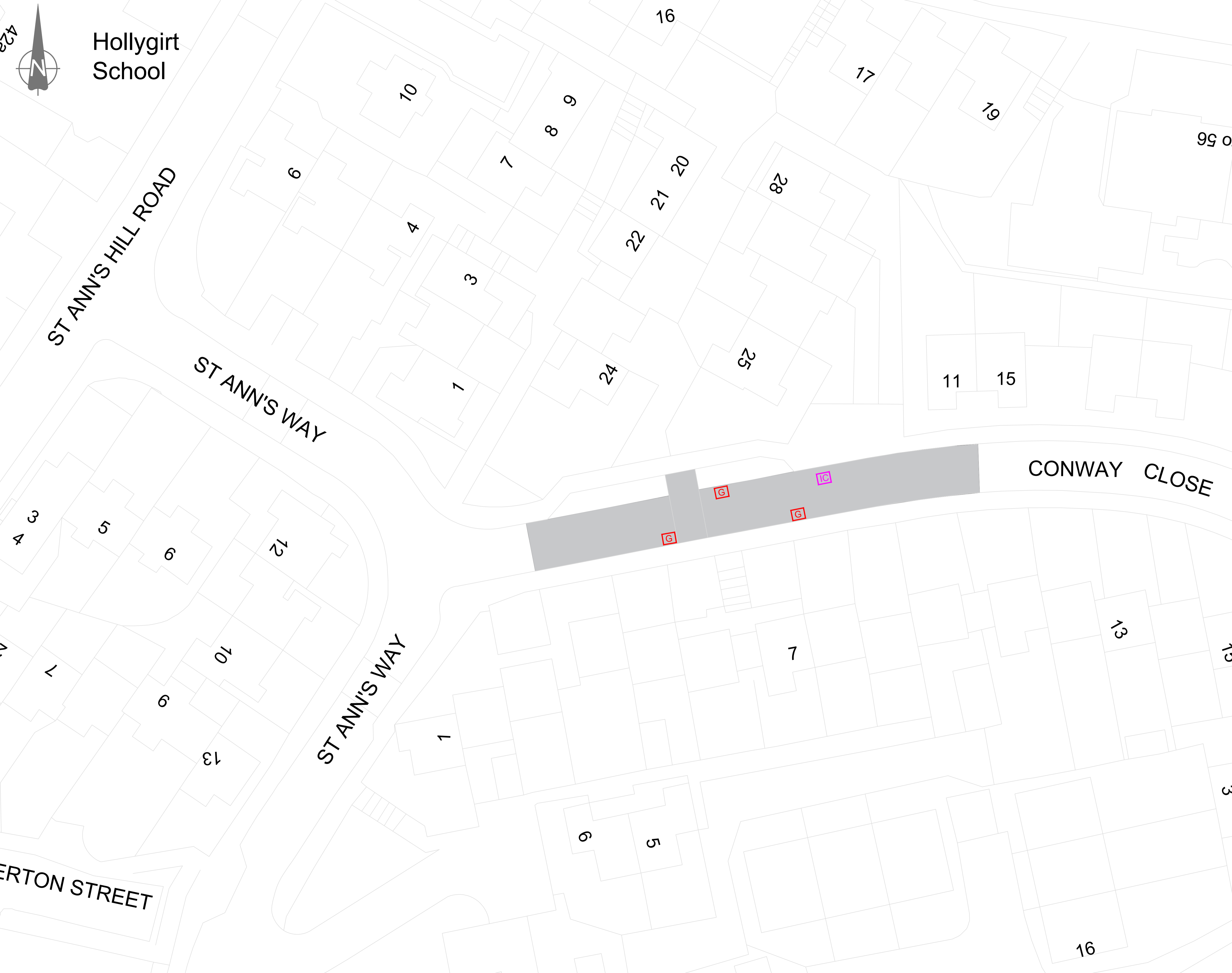

- Notes**
1. If this drawing has been issued electronically, it is the recipients responsibility to print the drawing to the correct scale.
 2. All dimensions in metres unless stated otherwise. DO NOT scale from this drawing, use written dimensions ONLY. Where additional information is required please contact the Engineer.
 3. All discrepancies are to be reported to the Engineer.
 4. Temporary traffic management to be in accordance with Chapter 8
 5. Pedestrian routes to remain available at all times
 6. All traffic signs and bollards to be installed with a minimum 450mm horizontal clearance from edge of carriageway unless stated otherwise
 7. For sign, post and foundation details refer to associated details in the accompanying construction pack
 8. All signs to have a clear anti-graffiti overlay applied over entire sign face

- Key**
- Remove & replace 3no. gully, cover and frames in carriageway.
 - Remove & replace 1no. inspection chamber, cover & frame in carriageway.
 - Extent of surfacing

This map is reproduced from Ordnance Survey material with the permission of Ordnance Survey on behalf of the Controller of Her Majesty's Stationery Office. Crown copyright and database rights. 2024. OS 400020222024. You are granted a non-exclusive, royalty free, revocable licence solely to view the Licensed Data for non-commercial purposes for the period during which Her Majesty's City Council makes it available. You are not permitted to copy, sub-license, distribute, sell or otherwise make available the Licensed Data to third parties in any form. Third party rights to enforce the terms of this licence shall be reserved to OS.

Rev.	Date	Details	By

Nottingham City Council

Resident Services | Highway Services
 Humber Building | Eastcroft Depot | London Road | NG2 3AH

Scheme
LTP 2024/25 Planned Carriageway Maintenance
Carriageway Surfacing

Title
Conway Close, St Anns Ward
Drainage

Drawn	Checked	Authorised
SC	MM	BB
Scale (printed @ A1)	Date	
NTS	15/07/2024	

Purpose of drawing
CONSTRUCTION

Drawing Number	Revision
HD/P24001/CONWA/500/001	

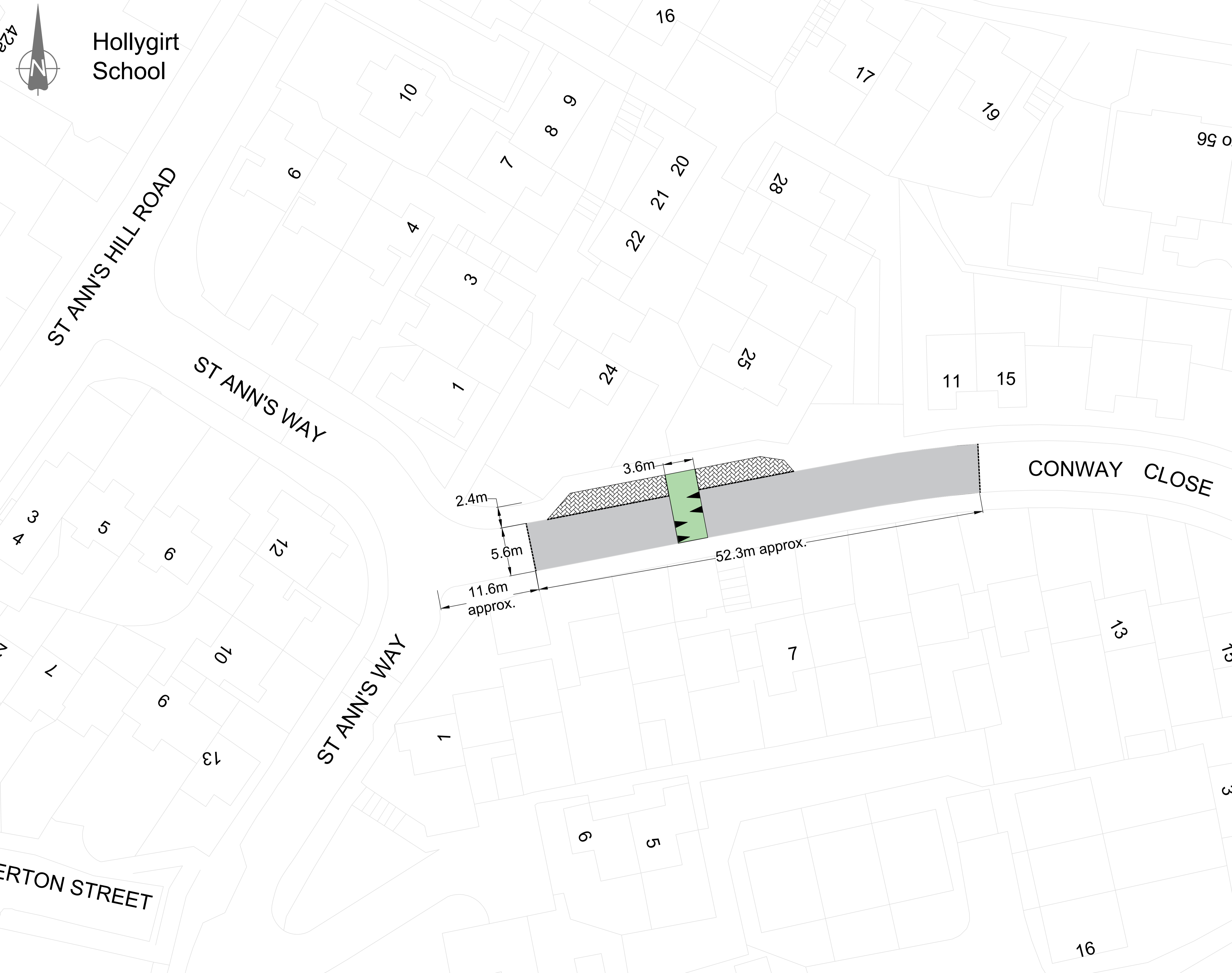

- Notes**
1. If this drawing has been issued electronically, it is the recipient's responsibility to print the drawing to the correct scale.
 2. All dimensions in metres unless stated otherwise. DO NOT scale from this drawing, use written dimensions ONLY. Where additional information is required please contact the Engineer.
 3. All discrepancies are to be reported to the Engineer.
 4. Temporary traffic management to be in accordance with Chapter 9
 5. Pedestrian routes to remain available at all times
 6. Where ironwork has been left proud of the surrounding surface, temporary ramping is to be provided in accordance with Clause 7774AR of the Specification.

- Key**
- Plane existing carriageway Approx. area of 307Sq.m including under road hump to 40mm depth.
 - 10 SMA Surf PMB (Min Binder Vol 13.5%, in-situ Air Voids <6%) PSV60+ 40mm depth With regulating course as required
 - Proposed Bituminous Road Humps to be constructed in accordance with Standard Detail (SD 700/30)
 - Overbanding
 - Existing block paving NOT to be removed

This map is reproduced from Ordnance Survey material with the permission of Ordnance Survey on behalf of the Controller of Her Majesty's Stationery Office. Crown copyright and database rights 2024. All rights reserved. No part of this publication may be reproduced, stored in a retrieval system, or transmitted in any form or by any means, electronic, mechanical, photocopying, recording, or otherwise, without the prior written permission of Ordnance Survey. This permission does not extend to other maps or publications available from Ordnance Survey. Ordnance Survey is a registered trademark of Ordnance Survey Limited.

Rev.	Date	Details	By

Nottingham City Council

Resident Services | Highway Services
 Humber Building | Eastcroft Depot | London Road | NG2 3AH

Scheme
LTP 2024/25 Planned Carriageway Maintenance Carriageway Surfacing

Title
Conway Close, St Anns Ward Planning

Drawn	Checked	Authorised
SC	MM	BB

Scale (printed @ A1) Date

NTS 15/07/2024

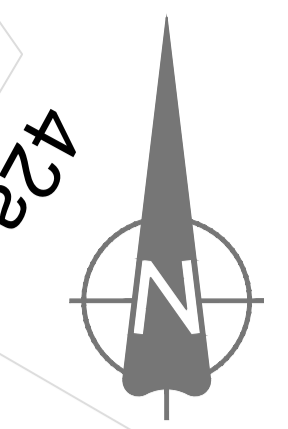

Purpose of drawing
CONSTRUCTION

Drawing Number	Revision
HD/P24001/CONWA/700/001	



Hollygirt School

- Notes**
1. If this drawing has been issued electronically, it is the recipients responsibility to print the drawing to the correct scale.
 2. All dimensions in metres unless stated otherwise. DO NOT scale from this drawing, use written dimensions ONLY. Where additional information is required please contact the Engineer.
 3. All discrepancies are to be reported to the Engineer.
 4. Temporary traffic management to be in accordance with Chapter 8
 5. Pedestrian routes to remain available at all times
 6. All traffic signs and bollards to be installed with a minimum 450mm horizontal clearance from edge of carriageway unless stated otherwise
 7. For sign, post and foundation details refer to associated details in the accompanying construction pack
 8. All signs to have a clear anti-graffiti overlay applied over entire sign face

- Key**
-  Proposed white thermoplastic road marking. Refer to HD/P22032/1200/001 for more details
 -  Proposed yellow thermoplastic road marking. Refer to HD/P22032/1200/001 for more details

This map is reproduced from Ordnance Survey material with the permission of Ordnance Survey on behalf of the Controller of Her Majesty's Stationery Office. Crown copyright and database rights. Data © Crown Copyright 2024. You are granted a non-exclusive, royalty free, revocable licence solely to view the Licensed Data for non-commercial purposes for the period being which Nottingham City Council makes it available. You are not permitted to copy, sub-license, distribute, sell or otherwise make available the Licensed Data to third parties in any form. Third party rights to enforce the terms of this licence shall be reserved to OS.

Rev.	Date	Details	By

Nottingham City Council

Resident Services | Highway Services
 Humber Building | Eastcroft Depot | London Road | NG2 3AH

Scheme
LTP 2024/25 Planned Carriageway Maintenance Carriageway Surfacing

Title
Conway Close, St AnnS Ward Carriageway Markings

Drawn	Checked	Authorised
SC	MM	BB

Scale (printed @ A1) Date
 NTS 15/07/2024

Purpose of drawing
CONSTRUCTION

Drawing Number	Revision
HD/P24001/CONWA/1200/001	