

Nottingham City Council

Application for a minor variation to a premises licence ~~or club premises certificate~~ under the Licensing Act 2003

PLEASE READ THE FOLLOWING INSTRUCTIONS FIRST

Before completing this form please read the Guidance Notes at the end of the form, especially Note 1.
If you are completing this form by hand please write legibly in block capitals. In all cases ensure that your answers are inside the boxes and in black ink. Use additional sheets if necessary.
Once completed please send your application to the relevant licensing authority. You may wish to keep a copy of the completed form for your records.

| |
|--|
| Mitchells & Butlers Leisure Retail Limited |
|--|

We being the premises licence holder(s) / ~~club holding a club premises certificate~~, apply to vary a premises licence under section 41A / ~~club premises certificate under section 86A~~ of the Licensing Act 2003 for the premises described in Part 1 below.

Part 1 – Premises details

| | |
|--|----------------------|
| Postal address of premises (or, if none, ordnance survey map reference, or description) Hemlock Stone Bramcote Lane Wollaton | |
| Post town Nottingham | Post Code NG8 2QQ |

Telephone number at premises (if any)

| |
|---------------|
| 0115 928 4463 |
|---------------|

Premises licence number/~~club premises certificate number~~

| |
|-------|
| 35664 |
|-------|

Brief description of premises (Please see Guidance Note 2)

| |
|-------------|
| As existing |
|-------------|

Part 2 – Applicant Details

Please tick

We are the premises licence holder/~~club premises certificate holder~~



Contact phone number in working hours (if any)

0121 498 4000

Applicant Postal address IF DIFFERENT FROM PREMISES ADDRESS

27 Fleet Street

Post town
Birmingham

Postcode
B3 1JP

Please provide email address if you would prefer us to contact you by email (optional)
licensing.admin@mbplc.com

Part 3 – Proposed variation(s)

Please tick ✓yes

Do you want the proposed variation to have effect as soon as possible?



Day Month Year

If not, from what date do you want the variation to take effect?

**FROM THE DATE
ON WHICH THE
COUNCIL ARE
NOTIFIED THAT
THE WORKS HAVE
BEEN COMPLETED**

Do you want the proposed variation to have effect in relation to the introduction of the late night levy? (Please see Guidance Note 3) Yes ☐ No ☒

Please describe the proposed variation(s) in detail in the box below and explain why you consider that they could not have an adverse effect on the promotion of any of the licensing objectives (See Guidance Note 1). This should include whether new or increased levels of licensable activities will be taking place indoors or outdoors (indoors may include a tent):

Details of proposed variations (Please see Guidance Note 4)

To vary the layout of the premises in accordance with plans (drawing number 2600-101) supplied by the applicant such variation to have effect upon the completion of the works as notified to the Licensing Authority in writing. Permitted hours and licensable activities remain as existing.

Details of proposed variations (Continued)

The alterations comprise:-

- Removal of stud walls and door to Snug area and new fixed seating
- New screen, backing onto the accessible WC
- Removal of screen in Dining area (top left of the plan)
- Removal of stud wall and new fire in dining/garden room
- To correct the existing plan by showing the red line behind the bar servery

Part 4 – Operating Schedule

Please tick those parts of the Operating Schedule which would be subject to change if this application to vary were successful.

Provision of regulated entertainment (Please see Guidance Note 5)

Please tick all that apply

- a. plays ☐
- b. films ☐
- c. indoor sporting events ☐
- d. boxing or wrestling entertainment ☐
- e. live music ☐
- f. recorded music ☐
- g. performances of dance ☐
- h. anything of a similar description to that falling within (e), (f) or (g) ☐

Provision of late night refreshment ☐

Sale by retail of alcohol ☐

(Note that this can only relate to reducing licensed hours, or moving them without any overall increase between 7am and 11pm)

Enclosures

- I have enclosed the premises licence/~~club premises certificate~~ ☒
- I have enclosed the relevant part of the premises licence/~~club premises certificate~~ ☒
- I have included a copy of the plan ☒
- (necessary if the proposed variation will affect the layout)

If you have not ticked one of the previous three boxes, please explain why in the box below.

Reasons why you have failed to enclose the premises licence/~~club premises certificate~~ or relevant parts.

N/A

Any further information to support your application. (See Guidance Note 6)

We have considered the proposed impact of the variation and do not consider that there will be any adverse effect on the promotion of the licensing objectives because the changes are minor. No further steps will be necessary to promote the licensing objectives and the existing measures will continue.

Application is submitted as a minor variation following consultation and agreement with Katie Jones, Licensing Officer.

CHECKLIST:

Please tick ✓ yes

- I have made or enclosed payment of the fee or ☒
- I have not made or enclosed payment of the fee because this application has been made in relation to the introduction of the late night levy. ☒
- I have enclosed the plan, if appropriate, of the premises ☒
- in scale (1mm to 100mm), unless otherwise agreed with the licensing authority

- I have enclosed the premises licence/~~club premises certificate~~ or relevant part of it or provided an explanation ☒
- I understand that if I do not comply with the above requirements my application will be rejected. ☒
- I understand that I am required to advertise my application by posting a white notice at or on the premises for ten consecutive working days commencing on, and including the day after the day when my application is given to the licensing authority. ☒

IT IS AN OFFENCE, UNDER SECTION 158 OF THE LICENSING ACT 2003, TO MAKE A FALSE STATEMENT IN OR IN CONNECTION WITH THIS APPLICATION. THOSE WHO MAKE A FALSE STATEMENT MAY BE LIABLE ON SUMMARY CONVICTION TO A FINE OF ANY AMOUNT.

Part 5 – Signatures and Contact Details
(See Guidance Note 7)

Premises Licence: Signature of applicant (the current premises licence holder) or applicant's solicitor or other duly authorised agent. (See Guidance Note 8) If signing on behalf of the applicant, please state your name and in what capacity you are authorised to sign:

Signature: 

Date: 4 June 2025

Capacity: We Poppleston Allen – Licensing Solicitors sign on behalf of and have authority to bind the applicant.

Where the premises licence is jointly held, signature of 2nd applicant (the current premises licence holder) or 2nd applicant's solicitor or other authorised agent (See Guidance Note 9). If signing on behalf of the applicant please state in what capacity.

Signature:

Date:

Capacity: I / We (insert full name and capacity) sign on behalf of and have authority to bind the applicant.

Where the premises is a club

I (insert full name) make this application on behalf of the club and have authority to bind the club

Signature:

Date:

Capacity: I / We (insert full name and capacity) sign on behalf of and have authority to bind the applicant.

| | |
|---|--|
| Contact name (where not previously given) and address for correspondence associated with this application. (See Guidance Note 10) Poppleston Allen Solicitors 37 Stoney Street The Lace Market Nottingham NG1 1LS | |
| Telephone number (if any) 0115 953 8509 | If you would prefer us to correspond with you by email your email address (optional) M.Peach@popall.co.uk |

Notes for Guidance

1. General Note: The minor variations process can only be used for variations that could have no adverse impact on the promotion of any of the four licensing objectives. (These are: the prevention of crime and disorder; public safety; the prevention of public nuisance; and the protection of children from harm.)

It cannot be used to:

- extend the period for which the licence or certificate has effect;
- transfer the licence or certificate from one premises to another;
- specify, in a premises licence, an individual as the premises supervisor
- add the sale by retail or supply of alcohol as an activity authorised by a licence or certificate;
- authorise the sale by retail or supply of alcohol at any time between 11pm and 7am;
- authorise an increase in the amount of time on any day during which alcohol may be sold by retail or supplied;
- include the alternative licence condition referred to in section 41D(3) in a premises licence.

2. Description of premises. For example the type of premises, its general situation and layout and any other information which could be relevant to the licensing objectives. This should include any activities in or associated with the use of the premises which may give rise to concern in respect of children regardless of whether you intend children to have access to the premises, for example (but not exclusively) nudity or semi-nudity, films for restricted age groups, the presence of gaming machines, etc.

3. You do not have to pay a fee if the only purpose of the variation for which you are applying is to avoid becoming liable to the late night levy.

4. Give full details of all the proposed variation(s). Failure to provide sufficient information may lead to the refusal of your application. Details should include a description of the proposed variation(s) in terms as precise as possible. If you are not precise, the licensing authority may decide that the changes you propose would be potentially broader in scope than you intend and reject your application as not being a 'minor' variation. You should also include a statement about why you consider the variations proposed could not have an impact on the licensing objectives listed in section 4(2) of the Act. You should cover each of the objectives that could possibly apply to your proposal (or if more than one, to each proposal) and say why you think there could be no adverse impact on that objective. Your application will be assisted by including as much information as you can about this. **(However, there is a box at the end of the form for 'further information', and this should be used for any relevant background information not directly related to the variation).** Relevant information includes:

- a) Variations to licensable activities/licensing hours** (all timings should be given in 24 hour clock (e.g. 16.00). Only give details for the days of the week when you intend the premises to be used for the activity), such as:
- Whether new or increased levels of licensable activities will be taking place indoors or outdoors. Indoors may include a tent;
 - Relevant further details, for example whether music will be amplified or unamplified;
 - Standard days and timing when the activity will take place, including start and finish times;
 - Any seasonal variations in timings, e.g. additional days during the summer;
 - Non-standard timings, e.g. where you wish the activity to go on longer on a particular day such as Christmas Eve.

b) Variations to premises/club layout: If you are applying for a variation to the layout of your premises, you must include a revised plan. You should be aware that your application is likely to be refused if the proposed variation could:

- increase capacity for drinking on the premises;
- affect access between the public part of the premises and the rest of the premises or the street or public way, e.g. block emergency exits or routes to emergency exits; or
- impede the effective operation of a noise reduction measure.

c) Revisions, removals and additions of conditions: The minor variation process may be used to remove conditions which are out of date or invalid and to revise conditions which are unclear (as long as the intention and effect remains the same). It can also be used to add a new condition volunteered by the applicant or mutually agreed between the applicant and a responsible authority, such as the police or the environmental health authority (subject to impact on the licensing objectives).

d) Variations to opening hours: Details of any changes to hours when the premises or club is open to the public.

5. In terms of specific regulated entertainments please note that:

- Plays: no licence is required for performances between 08.00 and 23.00 on any day, provided that the audience does not exceed 500.
- Films: no licence is required for 'not-for-profit' film exhibition held in community premises between 08.00 and 23.00 on any day provided that the audience does not exceed 500 and the organiser (a) gets consent to the screening from a person who is responsible for the premises; and (b) ensures that each such screening abides by age classification ratings.
- Indoor sporting events: no licence is required for performances between 08.00 and 23.00 on any day, provided that the audience does not exceed 1000.
- Boxing or Wrestling Entertainment: no licence is required for a contest, exhibition or display of Greco-Roman wrestling, or freestyle wrestling between 08.00 and 23.00 on any day, provided that the audience does not exceed 1000. Combined fighting sports – defined as a contest, exhibition or display which combines boxing or wrestling with one or more martial arts – are licensable as a boxing or wrestling entertainment rather than an indoor sporting event.
- Live music: no licence permission is required for:
 - a performance of unamplified live music between 08.00 and 23.00 on any day, on any premises.
 - a performance of amplified live music between 08.00 and 23.00 on any day on premises authorised to sell alcohol for consumption on those premises, provided that the audience does not exceed 500.
 - a performance of amplified live music between 08.00 and 23.00 on any day, in a workplace that is not licensed to sell alcohol on those premises, provided that the audience does not exceed 500.
 - a performance of amplified live music between 08.00 and 23.00 on any day, in a church hall, village hall, community hall, or other similar community premises, that is not licensed by a premises licence to sell alcohol, provided that (a) the audience does not exceed 500, and (b) the organiser gets consent for the performance from a person who is responsible for the premises.
 - a performance of amplified live music between 08.00 and 23.00 on any day, at the non-residential premises of (i) a local authority, or (ii) a school, or (iii) a hospital, provided that (a) the audience does not exceed 500, and (b) the organiser gets consent for the performance on the relevant premises from: (i) the local authority concerned, or (ii) the school or (iii) the health care provider for the hospital.
- Recorded Music: no licence permission is required for:
 - any playing of recorded music between 08.00 and 23.00 on any day on premises authorised to sell alcohol for consumption on those premises, provided that the audience does not exceed 500.
 - any playing of recorded music between 08.00 and 23.00 on any day, in a church hall, village hall, community hall, or other similar community premises, that is not licensed by a premises licence to sell alcohol, provided that (a) the audience does not exceed 500, and (b) the organiser gets consent for the performance from a person who is responsible for the premises.
 - any playing of recorded music between 08.00 and 23.00 on any day, at the non-residential premises of (i) a local authority, or (ii) a school, or (iii) a hospital, provided that (a) the audience does not exceed 500, and (b) the organiser gets consent for the

performance on the relevant premises from: (i) the local authority concerned, or (ii) the school proprietor or (iii) the health care provider for the hospital.

- Dance: no licence is required for performances between 08.00 and 23.00 on any day, provided that the audience does not exceed 500. However, a performance which amounts to adult entertainment remains licensable.
- Cross activity exemptions: no licence is required between 08.00 and 23.00 on any day, with no limit on audience size for:
 - any entertainment taking place on the premises of the local authority where the entertainment is provided by or on behalf of the local authority;
 - any entertainment taking place on the hospital premises of the health care provider where the entertainment is provided by or on behalf of the health care provider;
 - any entertainment taking place on the premises of the school where the entertainment is provided by or on behalf of the school proprietor; and
- any entertainment (excluding films and a boxing or wrestling entertainment) taking place at a travelling circus, provided that (a) it takes place within a moveable structure that accommodates the audience, and (b) that the travelling circus has not been located on the same site for more than 28 consecutive days.

6. Further information: You should use this box to provide any additional evidence to support your claim that the proposed variation is 'minor' and could not have an adverse impact on the promotion of the licensing objectives.

7. Signatures: The application form must be signed.

8. Authorised agent: An applicant's agent (e.g. solicitor) may sign the form on their behalf and, in so doing, will be confirming that they have actual authority to do so.

9. 2nd Applicant: Where there is more than one applicant both applicants or their respective agents must sign the application form.

10. This is the address which we shall use to correspond with you about this application. This might not be the same as the address of the premises or applicant, but these addresses must also be provided.”.

- Fire symbols
- Fire alarm call point
- Green em door release call point and test key
- Smoke detector
- Heat detector
- Fire blanket
- Alarm sounder
- Combined alarm sounder and smoke detector
- Fire action notice
- "Fire door keep closed" signage
- "Fire door keep locked" signage
- "Push bar to open" and "fire door keep clear" signage
- 30min fire door with intumescent smoke seals
- 60min fire door with intumescent smoke seals
- Self closing device
- Vision panel
- Push bar ironmongery
- 3 hour self contained non-maintained luminaire
- 3 hour self contained and maintained luminaire with directional arrow where necessary
- 3 hour self contained and maintained external luminaire
- Thumb turn door release - simple fastening
- Mechanical heavy usage Digilock door release - simple fastening with dual backplate and hold open function
- Xenon beacon unit with integral sounder to comply with the Equality Act 2010
- Recessed/surface mounted fire alarm zone indicator/control panel
- Magnetic door holder connected to fire alarm with fail safe release upon activation
- Magnetic lock and fixing brackets with digital access control panel and push button release
- Foam fire extinguisher
- Carbon Dioxide fire extinguisher
- Dry Powder fire extinguisher
- 9-litre water fire extinguisher
- Wet chemical fire extinguisher

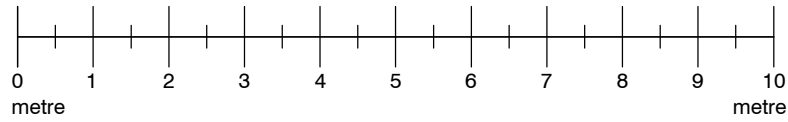

Licensing key

Areas for Licensable activities

Note:
Items shown on this plan which are not part of the statutory requirements are shown for indicative purposes only. This would include loose or fixed furniture in certain circumstances, the position of toilet cubicles, CCTV cameras and fire safety equipment not specified in the Regulations. These are shown upon the plans for illustrative purposes only and may be moved at the discretion of the license holder.

The current location of fire safety equipment and other safety equipment is not shown as these may be subject to variation in the future as necessary and where applicable in liaison with the Fire Officer. These may be subject to variation in the future as necessary and where applicable in liaison with the fire officer or after fire risk assessment.

© copyright

This drawing is the copyright of ABA architecture and interiors limited. Copyright is reserved by them and the drawing is issued on condition that it is not copied, reproduced, retained or disclosed to any unauthorised persons, either wholly or in part, without the written consent of ABA architecture and interiors limited. This drawing has been prepared for presentation purposes only. Consultants wishing to use the drawing for guidance must check all dimensions on site prior to finalising their element of work to be undertaken.

NOTE: Full survey not carried out - drawings and details produced from information provided by others and all are responsible for checking dimensions etc.

REV: DATE: BY: COMMENT:

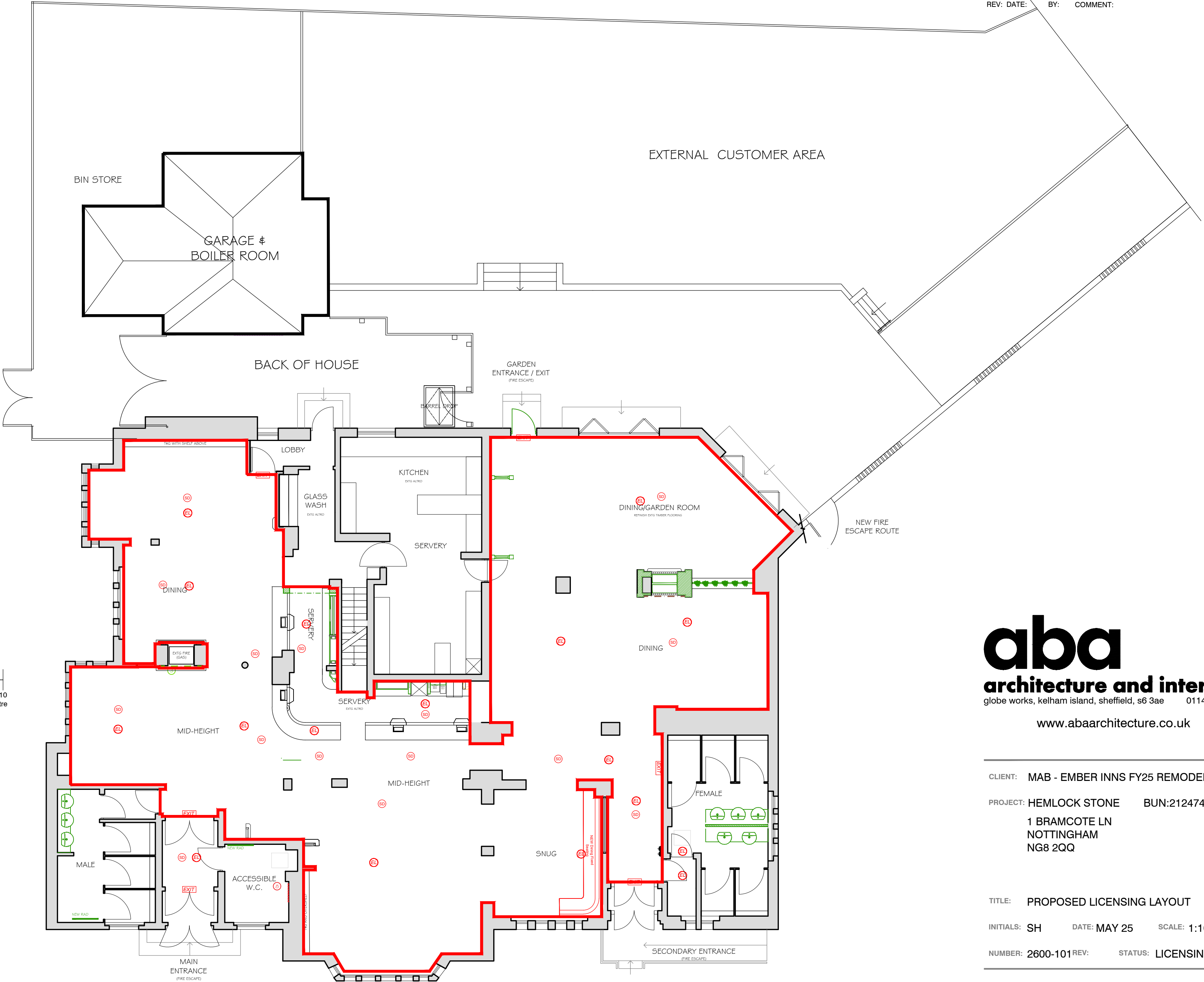

aba

architecture and interiors

globe works, kelham island, sheffield, s6 3ae 0114 201 5023

www.abaarchitecture.co.uk

CLIENT: MAB - EMBER INNS FY25 REMODEL

PROJECT: HEMLOCK STONE BUN:212474

1 BRAMCOTE LN
NOTTINGHAM
NG8 2QQ

TITLE: PROPOSED LICENSING LAYOUT

INITIALS: SH DATE: MAY 25 SCALE: 1:100 (A2)

NUMBER: 2600-101 REV: STATUS: LICENSING