

Application to vary a premises licence under the Licensing Act 2003

PLEASE READ THE FOLLOWING INSTRUCTIONS FIRST

Before completing this form please read the guidance notes at the end of the form. If you are completing this form by hand please write legibly in block capitals. In all cases ensure that your answers are inside the boxes and written in black ink. Use additional sheets if necessary.

You may wish to keep a copy of the completed form for your records.

We Be At One Limited

being the premises licence holder, apply to vary a premises licence under section 34 of the Licensing Act 2003 for the premises described in Part 1 below

Premises licence number 038410
--

Part 1 – Premises Details

Postal address of premises or, if none, ordnance survey map reference or description			
Be At One 20 Victoria Street			
Post town	Nottingham	Post code	NG1 2EX

Telephone number at premises (if any)	
Non-domestic rateable value of premises	£22,500

Part 2 – Applicant details

Daytime contact telephone number			
E-mail address (optional)			
Current residential address if different from premises address	3 Monkspath Hall Road		
Post Town	Solihull	Postcode	B90 4SJ

Part 3 - Variation

Please tick yes

Do you want the proposed variation to have effect as soon as possible?

If not, from what date do you want the variation to take effect?

Day	Month	Year

Do you want the proposed variation to have effect in relation to the introduction of the late night levy? (Please see guidance note 1) Yes No

Please describe briefly the nature of the proposed variation (Please read guidance note 2)

1. To vary the layout of the premises in accordance with plans supplied by the applicant Permitted hours and licensable activities to remain as existing.

Alterations include::

- To update licensing plans to show corrected red line licensed areas and layout of premises.
- To show reconfiguration of fixed seating, area to top left side of premises plan and main bar, previous trade space converted to new wash up and vacant space and new office to left of male toilets and new staff room (previous trade space) and cloakroom area to left of female toilets and blocking up one cubicle in female toilets
- To show addition of bar in existing licensed raised area and removal of section of fixed seating

If your proposed variation would mean that 5,000 or more people are expected to attend the premises at any one time, please state the number expected to attend

N/A

Part 4 Operating Schedule

Please complete those parts of the Operating Schedule below which would be subject to change if this application to vary is successful.

Provision of regulated entertainment (Please read guidance note 3)

Please tick all that apply

- | | |
|---|--------------------------|
| a) plays (if ticking yes, fill in box A) | <input type="checkbox"/> |
| b) films (if ticking yes, fill in box B) | <input type="checkbox"/> |
| c) indoor sporting events (if ticking yes, fill in box C) | <input type="checkbox"/> |
| d) boxing or wrestling entertainment (if ticking yes, fill in box D) | <input type="checkbox"/> |
| e) live music (if ticking yes, fill in box E) | <input type="checkbox"/> |
| f) recorded music (if ticking yes, fill in box F) | <input type="checkbox"/> |
| g) performances of dance (if ticking yes, fill in box G) | <input type="checkbox"/> |
| h) anything of a similar description to that falling within (e), (f) or (g) (if ticking yes, fill in box H) | <input type="checkbox"/> |

Provision of late night refreshment (if ticking yes, fill in box I)

Sale by retail of alcohol (if ticking yes, fill in box J)

In all cases complete boxes K, L and M

A

Plays Standard days and timings (please read guidance note 8)			Will the performance of a play take place indoors or outdoors or both – please tick (please read guidance note 4)	Indoors	<input type="checkbox"/>
				Outdoors	<input type="checkbox"/>
				Both	<input type="checkbox"/>
Day	Start	Finish	Please give further details here (please read guidance note 5)		
Mon					
Tue					
Wed			State any seasonal variations for performing plays (please read guidance note 6)		
Thur					
Fri			Non standard timings. Where you intend to use the premises for the performance of plays at different times to those listed in the column on the left, please list (please read guidance note 7)		
Sat					
Sun					

B- NO CHANGE

Films Standard days and timings (please read guidance note 8)			Will the exhibition of films take place indoors or outdoors or both – please tick (please read guidance note 4)	Indoors	<input type="checkbox"/>
				Outdoors	<input type="checkbox"/>
				Both	<input type="checkbox"/>
Day	Start	Finish	Please give further details here (please read guidance note 5)		
Mon					
Tue					
Wed			State any seasonal variations for the exhibition of films (please read guidance note 6)		
Thur					
Fri			Non standard timings. Where you intend to use the premises for the exhibition of films at different times to those listed in the column on the left, please list (please read guidance note 7)		
Sat					
Sun					

C

Indoor sporting events Standard days and timings (please read guidance note 8)			<u>Please give further details</u> (please read guidance note 5)
Day	Start	Finish	
Mon			<u>State any seasonal variations for indoor sporting events</u> (please read guidance note 6)
Tue			
Wed			
Thur			<u>Non standard timings. Where you intend to use the premises for indoor sporting events at different times to those listed in the column on the left, please list</u> (please read guidance note 7)
Fri			
Sat			
Sun			

D

Boxing or wrestling entertainments Standard days and timings (please read guidance note 8)			<u>Will the boxing or wrestling entertainment take place indoors or outdoors or both – please tick</u> (please read guidance note 4)	Indoors	<input type="checkbox"/>
Day	Start	Finish		Outdoors	<input type="checkbox"/>
Mon			<u>Please give further details here</u> (please read guidance note 5)	Both	<input type="checkbox"/>
Tue					
Wed					
Thur			<u>State any seasonal variations for boxing or wrestling entertainment</u> (please read guidance note 6)		
Fri					
Sat					
Sun					
			<u>Non standard timings. Where you intend to use the premises for boxing or wrestling entertainment at different times to those listed in the column on the left, please list</u> (please read guidance note 7)		

E- NO CHANGE

Live music Standard days and timings (please read guidance note 8)			Will the performance of live music take place indoors or outdoors or both – please tick (please read guidance note 4)	Indoors	<input type="checkbox"/>			
				Outdoors	<input type="checkbox"/>			
				Both	<input type="checkbox"/>			
Day	Start	Finish	Please give further details here (please read guidance note 5)					
Mon								
Tue								
Wed						State any seasonal variations for the performance of live music (please read guidance note 6)		
Thur								
Fri						Non standard timings. Where you intend to use the premises for the performance of live music at different times to those listed in the column on the left, please list (please read guidance note 7)		
Sat								
Sun								

F- NO CHANGE

Recorded music Standard days and timings (please read guidance note 8)			Will the playing of recorded music take place indoors or outdoors or both – please tick (please read guidance note 4)	Indoors	<input type="checkbox"/>			
				Outdoors	<input type="checkbox"/>			
				Both	<input type="checkbox"/>			
Day	Start	Finish	Please give further details here (please read guidance note 5)					
Mon								
Tue								
Wed						State any seasonal variations for the playing of recorded music (please read guidance note 6)		
Thur								
Fri						Non standard timings. Where you intend to use the premises for the playing of recorded music at different times to those listed in the column on the left, please list (please read guidance note 7)		
Sat								
Sun								

G

Performances of dance Standard days and timings (please read guidance note 8)			<u>Will the performance of dance take place indoors or outdoors or both – please tick</u> (please read guidance note 4)	Indoors	<input type="checkbox"/>
				Outdoors	<input type="checkbox"/>
Day	Start	Finish		Both	<input type="checkbox"/>
Mon			<u>Please give further details here</u> (please read guidance note 5)		
Tue					
Wed			<u>State any seasonal variations for the performance of dance</u> (please read guidance note 6)		
Thur					
Fri			<u>Non standard timings. Where you intend to use the premises for the performance of dance at different times to those listed in the column on the left, please list</u> (please read guidance note 7)		
Sat					
Sun					

H

Anything of a similar description to that falling within (e), (f) or (g) Standard days and timings (please read guidance note 8)			<u>Please give a description of the type of entertainment you will be providing</u>		
Day	Start	Finish	<u>Will this entertainment take place indoors or outdoors or both – please tick</u> (please read guidance note 4)	Indoors	<input type="checkbox"/>
Mon				Outdoors	<input type="checkbox"/>
				Both	<input type="checkbox"/>
Tue			<u>Please give further details here</u> (please read guidance note 5)		
Wed					
Thur			<u>State any seasonal variations for entertainment of a similar description to that falling within (e), (f) or (g)</u> (please read guidance note 6)		
Fri					
Sat			<u>Non standard timings. Where you intend to use the premises for the entertainment of a similar description to that falling within (e), (f) or (g) at different times to those listed in the column on the left, please list</u> (please read guidance note 7)		
Sun					

I- NO CHANGE

Late night refreshment Standard days and timings (please read guidance note 8)			Will the provision of late night refreshment take place indoors or outdoors or both – please tick (please read guidance note 4)	Indoors	<input type="checkbox"/>
				Outdoors	<input type="checkbox"/>
				Both	<input type="checkbox"/>
Day	Start	Finish			
Mon			Please give further details here (please read guidance note 5)		
Tue					
Wed			State any seasonal variations for the provision of late night refreshment (please read guidance note 6)		
Thur					
Fri			Non standard timings. Where you intend to use the premises for the provision of late night refreshment at different times, to those listed in the column on the left, please list (please read guidance note 7)		
Sat					
Sun					

J - NO CHANGE

Supply of alcohol Standard days and timings (please read guidance note 8)			Will the supply of alcohol be for consumption (Please tick box) (please read guidance note 9)	On the premises	<input type="checkbox"/>
				Off the premises	<input type="checkbox"/>
				Both	<input type="checkbox"/>
Day	Start	Finish			
Mon			State any seasonal variations for the supply of alcohol (please read guidance note 6)		
Tue					
Wed					
Thur			Non-standard timings. Where you intend to use the premises for the supply of alcohol at different times to those listed in the column on the left, please list (please read guidance note 7)		
Fri					
Sat					
Sun					

K

Please highlight any adult entertainment or services, activities, other entertainment or matters ancillary to the use of the premises that may give rise to concern in respect of children (please read guidance note 8)
As existing/ no change

L- NO CHANGE

Hours premises are open to the public Standard days and timings (please read guidance note 8)			State any seasonal variations (please read guidance note 6)
Day	Start	Finish	
Mon			
Tue			
Wed			
Thur			
Fri			
Sat			
Sun			Non standard timings. Where you intend the premises to be open to the public at different times from those listed in the column on the left, please list (please read guidance note 7)

Please identify those conditions currently imposed on the licence which you believe could be removed as a consequence of the proposed variation you are seeking

None

Please tick yes

- I have enclosed the premises licence
- I have enclosed the relevant part of the premises licence

If you have not ticked one of these boxes please fill in reasons for not including the licence, or part of it, below

Reasons why I have failed to enclose the premises licence or relevant part of premises licence

N/A

M Describe any additional steps you intend to take to promote the four licensing objectives as a result of the proposed variation:

a) General – all four licensing objectives (b,c,d,e) (please read guidance note 11)

[The information provided in this box is solely for information only and not intended to be converted into conditions on the licence]

We have considered the impact of the proposed variation which seeks to alter the layout of the licensing plans in accordance with the proposed plan supplied by the applicant.

Alterations include:

- To update licensing plans to show corrected red line licensed area and layout of premises*
- To show reconfiguration of fixed seating, area to top left side of premises plan and main bar, new wash up and vacant space and office to left of male toilets and new staff and cloakroom area to left of female toilets and blocking up one cubicle in female toilets*
- To show addition of bar in existing licensed raised area and removal of section of fixed seating*

This application does not seek to extend permitted hours for sale of alcohol or other licensable activities it is solely to approve the change to the layout of the premises as part of a refurbishment and existing conditions imposed on the licence and measures in place will continue to apply. We do not consider the application will undermine the promotion of the licensing objectives and no further steps will be necessary to promote the licensing objectives and the existing measures will continue.

b) The prevention of crime and disorder

Please see box a) above.

c) Public safety

Please see box a) above.

d) The prevention of public nuisance

Please see box a) above.

e) The protection of children from harm

Please see box a) above.

Please tick yes

- I have made or enclosed payment of the fee or
- I have not made or enclosed payment of the fee because this application has been made in relation to the introduction of the late night levy

- I have sent copies of this application and the plan to responsible authorities and others where applicable
- I understand that I must now advertise my application
- I have enclosed the premises licence or relevant part of it or explanation
- I understand that if I do not comply with the above requirements my application will be rejected

IT IS AN OFFENCE, UNDER SECTION 158 OF THE LICENSING ACT 2003, TO MAKE A FALSE STATEMENT IN OR IN CONNECTION WITH THIS APPLICATION. THOSE WHO MAKE A FALSE STATEMENT MAY BE LIABLE ON SUMMARY CONVICTION TO A FINE OF ANY AMOUNT.

Part 5 – Signatures (please read guidance note 12)

Signature of applicant (the current premises licence holder) or applicant’s solicitor or other duly authorised agent (please read guidance note 13). **If signing on behalf of the applicant please state in what capacity.**

Signature	
Date	14/06/2024
Capacity	Poppleston Allen – Solicitors for & on behalf of the applicant

Where the premises licence is jointly held signature of 2nd applicant (the current premises licence holder) or 2nd applicant’s solicitor or other authorised agent (please read guidance note 14). **If signing on behalf of the applicant please state in what capacity.**

Signature	
Date	
Capacity	

Contact name (where not previously given) and address for correspondence associated with this application (please read guidance note 15) Suraj Desor Poppleston Allen Solicitors 37 Stoney Street The Lace Market			
Post town	Nottingham	Post code	NG1 1LS
Telephone number (if any)	0115 953 8500		
If you would prefer us to correspond with you by e-mail your e-mail address (optional) s.desor@popall.co.uk			

Notes for Guidance

This application cannot be used to vary the licence so as to extend the period for which the licence has effect or to vary substantially the premises to which it relates. If you wish to make that type of change to the premises licence you should make a new premises licence application under section 17 of the Licensing Act 2003.

1. You do not have to pay a fee if the only purpose of the variation for which you are applying is to avoid becoming liable for the late night levy
2. Describe the premises. For example the type of premises, its general situation and layout and any other information which could be relevant to the licensing objectives. Where your application includes off-supplies of alcohol and you intend to provide a place for consumption of these off-supplies you must include a description of where the place will be and its proximity to the premises.
3. In terms of specific regulated entertainments please note that:
 - Plays: no licence is required for performances between 08.00 and 23.00 on any day, provided that the audience does not exceed 500.
 - Films: no licence is required for 'not-for-profit' film exhibition held in community premises between 08.00 and 23.00 on any day provided that the audience does not exceed 500 and the organiser (a) gets consent to the screening from a person who is responsible for the premises; and (b) ensures that each such screening abides by age classification ratings.
 - Indoor sporting events: no licence is required for performances between 08.00 and 23.00 on any day, provided that the audience does not exceed 1000.
 - Boxing or Wrestling Entertainment: no licence is required for a contest, exhibition or display of Greco-Roman wrestling, or freestyle wrestling between 08.00 and 23.00 on any day, provided that the audience does not exceed 1000. Combined fighting sports – defined as a contest, exhibition or display which combines boxing or wrestling with one or more martial arts – are licensable as a boxing or wrestling entertainment rather than an indoor sporting event.
 - Live music: no licence permission is required for:
 - a performance of unamplified live music between 08.00 and 23.00 on any day, on any premises.
 - a performance of amplified live music between 08.00 and 23.00 on any day on premises authorised to sell alcohol for consumption on those premises, provided that the audience does not exceed 500.
 - a performance of amplified live music between 08.00 and 23.00 on any day, in a workplace that is not licensed to sell alcohol on those premises, provided that the audience does not exceed 500.
 - a performance of amplified live music between 08.00 and 23.00 on any day, in a church hall, village hall, community hall, or other similar community premises, that is not licensed by a premises licence to sell alcohol, provided that (a) the audience does not exceed 500, and (b) the organiser gets consent for the performance from a person who is responsible for the premises.
 - a performance of amplified live music between 08.00 and 23.00 on any day, at the non-residential premises of (i) a local authority, or (ii) a school, or (iii) a hospital, provided that (a) the audience does not exceed 500, and (b) the organiser gets consent for the performance on the relevant premises from: (i) the local authority concerned, or (ii) the school or (iii) the health care provider for the hospital.
 - Recorded Music: no licence permission is required for:
 - any playing of recorded music between 08.00 and 23.00 on any day on premises authorised to sell alcohol for consumption on those premises, provided that the audience does not exceed 500.
 - any playing of recorded music between 08.00 and 23.00 on any day, in a church hall, village hall, community hall, or other similar community premises, that is not licensed by a premises licence to sell alcohol, provided that (a) the audience does not exceed 500, and (b) the organiser gets consent for the performance from a person who is responsible for the premises.
 - any playing of recorded music between 08.00 and 23.00 on any day, at the non-residential premises of (i) a local authority, or (ii) a school, or (iii) a hospital, provided that (a) the audience does not exceed 500, and (b) the organiser gets consent for the performance on the relevant premises from: (i)

the local authority concerned, or (ii) the school proprietor or (iii) the health care provider for the hospital.

- Dance: no licence is required for performances between 08.00 and 23.00 on any day, provided that the audience does not exceed 500. However, a performance which amounts to adult entertainment remains licensable.
 - Cross activity exemptions: no licence is required between 08.00 and 23.00 on any day, with no limit on audience size for:
 - any entertainment taking place on the premises of the local authority where the entertainment is provided by or on behalf of the local authority;
 - any entertainment taking place on the hospital premises of the health care provider where the entertainment is provided by or on behalf of the health care provider;
 - any entertainment taking place on the premises of the school where the entertainment is provided by or on behalf of the school proprietor; and
 - any entertainment (excluding films and a boxing or wrestling entertainment) taking place at a travelling circus, provided that (a) it takes place within a moveable structure that accommodates the audience, and (b) that the travelling circus has not been located on the same site for more than 28 consecutive days.
4. Where taking place in a building or other structure please tick as appropriate. Indoors may include a tent.
 5. For example state type of activity to be authorised, if not already stated, and give relevant further details, for example (but not exclusively) whether or not music will be amplified or unamplified.
 6. For example (but not exclusively), where the activity will occur on additional days during the summer months.
 7. For example (but not exclusively), where you wish the activity to go on longer on a particular day e.g. Christmas Eve.
 8. Please give timings in 24 hour clock (e.g. 16:00) and only give details for the days of the week when you intend the premises to be used for the activity.
 9. If you wish people to be able to consume alcohol on the premises please tick on, if you wish people to be able to purchase alcohol to consume away from the premises please tick off. If you wish people to be able to do both please tick both.
 10. Please give information about anything intended to occur at the premises or ancillary to the use of the premises which may give rise to concern in respect of children regardless of whether you intend children to have access to the premises, for example (but not exclusively) nudity or semi-nudity, films for restricted age groups or the presence of gaming machines.
 11. Please list here steps you will take to promote all four licensing objectives together.
 12. The application form must be signed.
 13. An applicant's agent (for example solicitor) may sign the form on their behalf provided that they have actual authority to do so.
 14. Where there is more than one applicant, both applicants or their respective agents must sign the application form.
 15. This is the address which we shall use to correspond with you about this application.
 - 16.

- Main contractor to ensure that all parties refer to drawing xxxx-xx-xxx for standard construction notation, and ensure that all materials are fit for purpose prior to order. All works, quantities and corresponding costs to be approved by Project Manager and QS prior to order, application, construction or manufacture.
- All suppliers listed are indicative only - Main contractor to seek competitive quotes for all elements on a like for like basis, any alternative specifications to be presented to Architect and Designer for approval prior to order.
- Structural components to be detailed by Structural Engineer in accordance with current Building Regulations.
- All site dimensions to be confirmed by Main contractor to other parties as necessary prior to manufacture, order or fabrication.
- All specifications to satisfy all statutory and local requirements, and be to the satisfaction of Designer. It is the nominated supplier's responsibility to ensure that all specifications are fully compliant with all relevant applicable British Standards. All works to be carried out in strict accordance with the Building Regulations as Present, Latest Amendments and to the satisfaction of the Building Surveyor (Max 30m) to be Class 3, unless specified otherwise by nominated Fire Consultant. NB Suppliers to be responsible for ensuring that any specialist finishes or materials comply with the required rating (and obtain written evidence of compliance to be passed to Designer), OR to check and be responsible for achieving any requirements in excess of these standards.
- All specifications to be agreed with Designer.
- All acoustic works to be confirmed by Acoustic consultant - refer to separate consultants drawing where applicable and when required.
- All works to be by Main contractor unless otherwise stated.
- Main contractor to liaise with Architect and Designer over exact ceiling requirements and inform all relevant parties of ceiling construction to enable integration of lights, ducting etc. prior to start on site.
- Main contractor to liaise with Architect over fire compartmentation requirements and fire barrier setting-out. Impact on finished ceilings to be assessed and any conflicts brought to the attention of the Designer and Architect. Any fire barrier to be retained entirely and made good like for like, if disturbed during other contracted works.
- All bespoke items to be coordinated between manufacturer and Designer. Wherever possible, details and finished samples to be provided to Designer for approval prior to order.
- All ceilings to be made good where necessary unless otherwise specified, ready to receive finishes.
- All ceilings to be suitably prepared by Main contractor prior to application i.e. apply base coats, silk finish etc. Specialist painter to apply suitable glaze to final applications where appropriate.
- Samples of all paint finishes to be provided by Main contractor for approval by Designer prior to application.
- All 'wet areas' such as bars, glass-wash, toilets etc., etc. to receive anti-fungal/quality finish.
- Any exposed structural steel elements to receive intumescent paint finish. Intumescent finishes to be applied as per Building Regulations, generally 60 minutes fire resistance.
- Main contractor to ascertain requirements prior to application of any finishes and liaise with Architect and Designer prior to start on site and confirm what type of specification chosen.
- Samples of all stairs and paint finishes to be provided by Main contractor for approval by Designer prior to application.
- Main contractor to make allowances for access hatches where required. Locations of all ceiling access hatches to be provided to Designer prior to start on site. All contractors must conform with all access requirements with Main contractor prior to construction of ceilings.
- All ceiling heights shown are fff unless otherwise stated.
- Over staircases min 2000mm headroom from pitch to be achieved at a minimum.
- All ceiling heights shown are indicative of Design intentions only and are 'ideal heights' subject to feasibility afforded by existing ceilings and M&E installations - final heights to be agreed with Designer and Architect in due course.
- All false ceilings to allow for concealed M&E installations above - Main contractor to highlight any potential conflicts to Designer prior to installation and agree revision. Layout to be finalised subject to Mechanical layout from nominated contractor, read drawing in conjunction with installer drawing ref. fbc.
- Any new roof void above suspended ceilings to have automatic fire detection fittings, all designed and installed by nominated electrical contractor and connected to fire alarm system and certified with certificates supplied to Architect - Designer.
- Drawing to be read in conjunction with appropriate details and BS's.
- Fire Strategy and Building Regulations drawings.

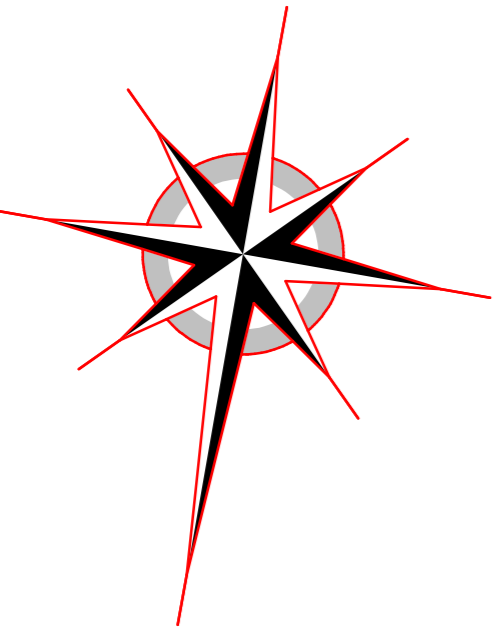

Do not scale off this drawing. All dimensions to be checked on site prior to construction. All dimensions to be checked on site prior to construction. All dimensions to be checked on site prior to construction.

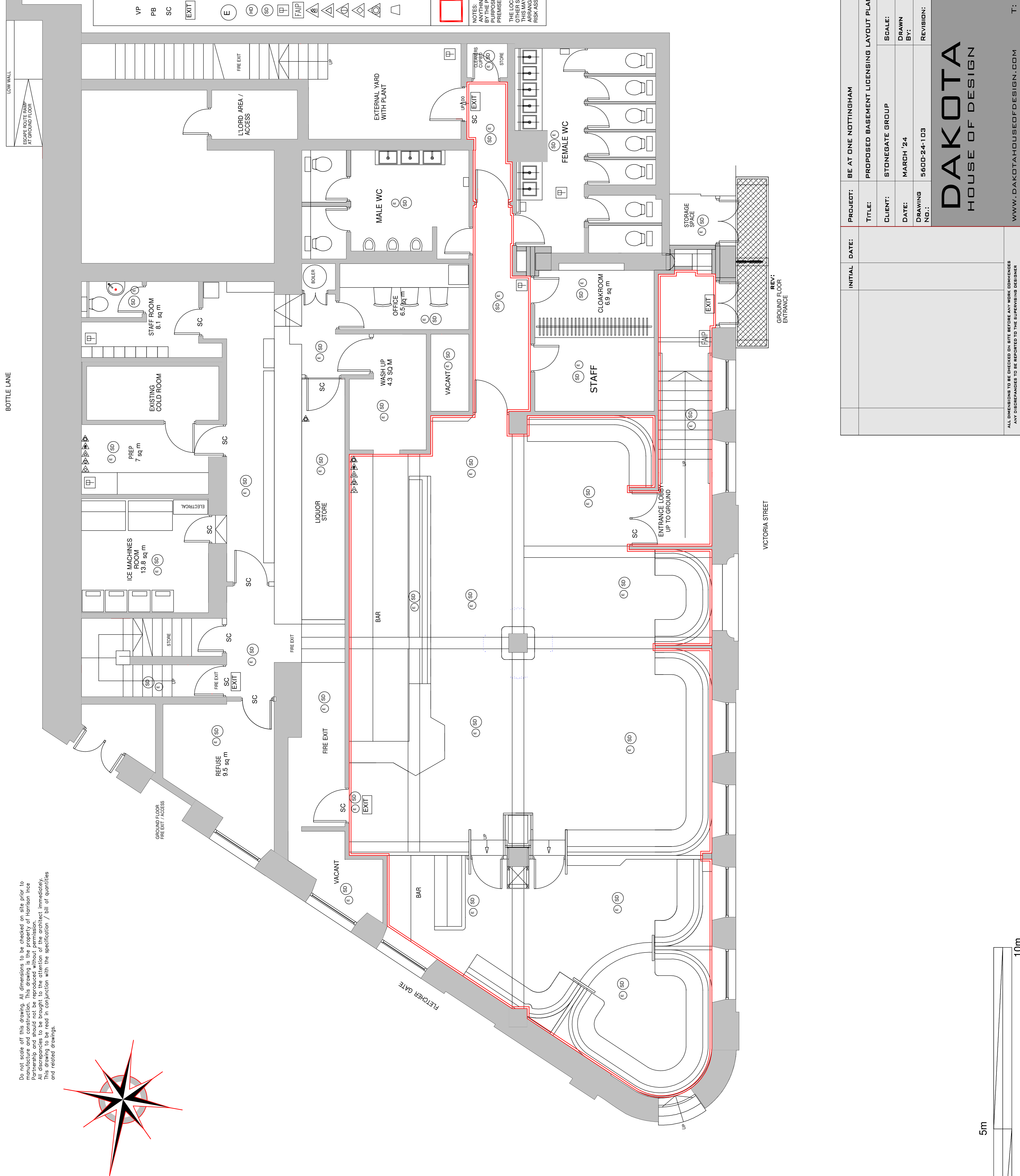

FIRE AUTHORITY REQUIREMENTS	
VP	VISION PANEL
PB	PANIC BOLT
SC	SELF-CLOSING
[EXIT]	SELF CONTAINED MAINTAINED DIRECTIONAL EMERGENCY EXIT SIGN ILLUMINATED SUSPENDED *FIRE EXIT SIGN 75mm LETTERS
(E)	AREA COVERED BY MAINTAINED EMERGENCY LIGHT FITTING TO BS5586: PART 1
(HD)	AREA COVERED BY HEAT DETECTORS
(SD)	AREA COVERED BY SMOKE DETECTORS
[TP]	FIRE ALARM CALL POINT
[FAP]	FIRE ALARM INDICATOR PANEL
[E]	FIRE BLANKET IN CONTAINER
[E]	CARBON DIOXIDE FIRE EXTINGUISHER
[E]	9 LITRE WATER EXTINGUISHER
[E]	DRY POWDER EXTINGUISHER
[E]	FOAM FIRE EXTINGUISHER
[E]	FOAM FIRE EXTINGUISHER
[E]	ALARM WARNING DEVICE (voice type in Customer Areas)
[E]	music sound system to be de-activated.
[]	LICENSEABLE ACTIVITIES

NOTES:
 ANYTHING SHOWN ON THIS PLAN WHICH IS NOT REQUIRED BY THE BUILDING REGULATIONS OR FIRE SAFETY PURPOSES CAN AND DOES NOT FORM PART OF THE PREMISES LICENCE.
 THE LOCATION AND TYPE OF ANY FIRE SAFETY AND ANY OTHER SAFETY EQUIPMENT IS SHOWN AS AT PRESENT. THIS MAY VARY FROM TIME TO TIME WITH THE ARRANGEMENT OF THE FIRE OFFICER OR AFTER A FIRE RISK ASSESSMENT.

PROJECT:	BE AT ONE NOTTINGHAM	INITIAL:		DATE:	
TITLE:	PROPOSED BASEMENT LICENSING LAYOUT PLANS	CLIENT:	STONEGATE GROUP	SCALE:	1:50 @ A1
DATE:	MARCH '24	DRAWN BY:	TN	TENDER:	
DRAWING NO.:	5600-24-1 03	REVISION:		CONSTRUCTION:	
<p>1 DINDSDALE PLACE SANDYFORD NEWCASTLE UPON TYNE NE2 1BD UNITED KINGDOM</p>					

