

## Application to vary a premises licence under the Licensing Act 2003

### PLEASE READ THE FOLLOWING INSTRUCTIONS FIRST

Before completing this form please read the guidance notes at the end of the form. If you are completing this form by hand please write legibly in block capitals. In all cases ensure that your answers are inside the boxes and written in black ink. Use additional sheets if necessary.

You may wish to keep a copy of the completed form for your records.

I/We B & M Retail Limited

*(Insert name(s) of applicant)*

being the premises licence holder, apply to vary a premises licence under section 34 of the Licensing Act 2003 for the premises described in Part 1 below

<b>Premises licence number</b> 191335
--

#### Part 1 – Premises Details

Postal address of premises or, if none, ordnance survey map reference or description  B & M Store 36-48 Main Street			
Post town	Nottingham	Postcode	NG6 8EW

Telephone number at premises (if any)	
Non-domestic rateable value of premises	£168,000

#### Part 2 – Applicant details

Daytime contact telephone number	c/o 07423 640 206		
E-mail address (optional)	c/o enquiries@bmstores.co.uk		
Current postal address if different from premises address			
Post town		Postcode	

**Part 3 - Variation**

Please tick as appropriate

Do you want the proposed variation to have effect as soon as possible?      Yes

If not, from what date do you want the variation to take effect?

DD	MM	YYYY
<input type="text"/>	<input type="text"/>	<input type="text"/>

Do you want the proposed variation to have effect in relation to the introduction of the late night levy? (Please see guidance note 1)       No

**Please describe briefly the nature of the proposed variation** (Please see guidance note 2)

To vary the layout of the premises to remove the fire exit located at the back of the store on the ground floor. This door will now be fixed closed.

No other changes are being sought.

If your proposed variation would mean that 5,000 or more people are expected to attend the premises at any one time, please state the number expected to attend:

## Part 4 Operating Schedule

Please complete those parts of the Operating Schedule below which would be subject to change if this application to vary is successful.

- | <b>Provision of regulated entertainment (Please see guidance note 3)</b>                                    | <b>Please tick all that apply</b> |
|---|-----------------------------------|
| a) plays (if ticking yes, fill in box A)  | <input type="checkbox"/>          |
| b) films (if ticking yes, fill in box B)  | <input type="checkbox"/>          |
| c) indoor sporting events (if ticking yes, fill in box C)   | <input type="checkbox"/>          |
| d) boxing or wrestling entertainment (if ticking yes, fill in box D)  | <input type="checkbox"/>          |
| e) live music (if ticking yes, fill in box E)   | <input type="checkbox"/>          |
| f) recorded music (if ticking yes, fill in box F)   | <input type="checkbox"/>          |
| g) performances of dance (if ticking yes, fill in box G)  | <input type="checkbox"/>          |
| h) anything of a similar description to that falling within (e), (f) or (g) (if ticking yes, fill in box H) | <input type="checkbox"/>          |

**Provision of late night refreshment** (if ticking yes, fill in box I)

**Supply of alcohol** (if ticking yes, fill in box J)

**In all cases complete boxes K, L and M**

A

Plays Standard days and timings (please read guidance note 8)			Will the performance of a play take place <u>indoors or outdoors or both – please tick</u> (please read guidance note 4)	Indoors	<input type="checkbox"/>
				Outdoors	<input type="checkbox"/>
Day	Start	Finish		Both	<input type="checkbox"/>
Mon			<u>Please give further details here</u> (please read guidance note 5)		
Tue			<u>State any seasonal variations for performing plays</u> (please read guidance note 6)		
Wed			<u>Non standard timings. Where you intend to use the premises for the performance of plays at different times to those listed in the column on the left, please list</u> (please read guidance note 7)		
Thur					
Fri					
Sat					
Sun					

B

Films Standard days and timings (please read guidance note 8)			<u>Will the exhibition of films take place indoors or outdoors or both – please tick</u> (please read guidance note 4)	Indoors	<input type="checkbox"/>
				Outdoors	<input type="checkbox"/>
				Both	<input type="checkbox"/>
Day	Start	Finish			
Mon			<u>Please give further details here</u> (please read guidance note 5)		
Tue					
Wed			<u>State any seasonal variations for the exhibition of films</u> (please read guidance note 6)		
Thur					
Fri			<u>Non standard timings. Where you intend to use the premises for the exhibition of films at different times to those listed in the column on the left, please list</u> (please read guidance note 7)		
Sat					
Sun					

C

Indoor sporting events Standard days and timings (please read guidance note 8)			<u>Please give further details</u> (please read guidance note 5)
Day	Start	Finish	
Mon			
Tue			<u>State any seasonal variations for indoor sporting events</u> (please read guidance note 6)
Wed			
Thur			<u>Non standard timings. Where you intend to use the premises for indoor sporting events at different times to those listed in the column on the left, please list</u> (please read guidance note 7)
Fri			
Sat			
Sun			

D

Boxing or wrestling entertainments Standard days and timings (please read guidance note 8)			<u>Will the boxing or wrestling entertainment take place indoors or outdoors or both – please tick</u> (please read guidance note 4)	Indoors	<input type="checkbox"/>																							
				Outdoors	<input type="checkbox"/>																							
<table border="1"> <thead> <tr> <th>Day</th> <th>Start</th> <th>Finish</th> </tr> </thead> <tbody> <tr> <td>Mon</td> <td></td> <td></td> </tr> <tr> <td>Tue</td> <td></td> <td></td> </tr> <tr> <td>Wed</td> <td></td> <td></td> </tr> <tr> <td>Thur</td> <td></td> <td></td> </tr> <tr> <td>Fri</td> <td></td> <td></td> </tr> <tr> <td>Sat</td> <td></td> <td></td> </tr> <tr> <td>Sun</td> <td></td> <td></td> </tr> </tbody> </table>				Day	Start	Finish	Mon			Tue			Wed			Thur			Fri			Sat			Sun			Both
Day	Start	Finish																										
Mon																												
Tue																												
Wed																												
Thur																												
Fri																												
Sat																												
Sun																												
			<u>Please give further details here</u> (please read guidance note 5)																									
			<u>State any seasonal variations for boxing or wrestling entertainment</u> (please read guidance note 6)																									
			<u>Non standard timings. Where you intend to use the premises for boxing or wrestling entertainment at different times to those listed in the column on the left, please list</u> (please read guidance note 7)																									

E

Live music Standard days and timings (please read guidance note 8)			Will the performance of live music take place <u>indoors or outdoors or both – please tick</u> (please read guidance note 4)	Indoors	<input type="checkbox"/>
				Outdoors	<input type="checkbox"/>
Day	Start	Finish		Both	<input type="checkbox"/>
Mon			<u>Please give further details here</u> (please read guidance note 5)		
Tue			<u>State any seasonal variations for the performance of live music</u> (please read guidance note 6)		
Wed			<u>Non standard timings. Where you intend to use the premises for the performance of live music at different times to those listed in the column on the left, please list</u> (please read guidance note 7)		
Thur					
Fri					
Sat					
Sun					



F

Recorded music Standard days and timings (please read guidance note 8)			Will the playing of recorded music take place <u>indoors or outdoors or both – please tick</u> (please read guidance note 4)	Indoors	<input type="checkbox"/>
				Outdoors	<input type="checkbox"/>
				Both	<input type="checkbox"/>
Day	Start	Finish			
Mon			<u>Please give further details here</u> (please read guidance note 5)		
Tue					
Wed			<u>State any seasonal variations for the playing of recorded music</u> (please read guidance note 6)		
Thur					
Fri			<u>Non standard timings. Where you intend to use the premises for the playing of recorded music at different times to those listed in the column on the left, please list</u> (please read guidance note 7)		
Sat					
Sun					

G

Performances of dance Standard days and timings (please read guidance note 8)			<b><u>Will the performance of dance take place indoors or outdoors or both – please tick</u></b> (please read guidance note 4)	Indoors	<input type="checkbox"/>
Day	Start	Finish		Outdoors	<input type="checkbox"/>
				Both	<input type="checkbox"/>
Mon			<b><u>Please give further details here</u></b> (please read guidance note 5)		
Tue			<b><u>Please give further details here</u></b> (please read guidance note 5)		
Wed			<b><u>State any seasonal variations for the performance of dance</u></b> (please read guidance note 6)		
Thur			<b><u>State any seasonal variations for the performance of dance</u></b> (please read guidance note 6)		
Fri			<b><u>Non standard timings. Where you intend to use the premises for the performance of dance at different times to those listed in the column on the left, please list</u></b> (please read guidance note 7)		
Sat			<b><u>Non standard timings. Where you intend to use the premises for the performance of dance at different times to those listed in the column on the left, please list</u></b> (please read guidance note 7)		
Sun			<b><u>Non standard timings. Where you intend to use the premises for the performance of dance at different times to those listed in the column on the left, please list</u></b> (please read guidance note 7)		

H

<b>Anything of a similar description to that falling within (e), (f) or (g)</b> Standard days and timings (please read guidance note 8)			Please give a description of the type of entertainment you will be providing		
Day	Start	Finish	<b><u>Will this entertainment take place indoors or outdoors or both – please tick</u></b> (please read guidance note 4)	Indoors	<input type="checkbox"/>
Mon				Outdoors	<input type="checkbox"/>
				Both	<input type="checkbox"/>
Tue			<b><u>Please give further details here</u></b> (please read guidance note 5)		
Wed					
Thur			<b><u>State any seasonal variations for entertainment of a similar description to that falling within (e), (f) or (g)</u></b> (please read guidance note 6)		
Fri					
Sat			<b><u>Non standard timings. Where you intend to use the premises for the entertainment of a similar description to that falling within (e), (f) or (g) at different times to those listed in the column on the left, please list</u></b> (please read guidance note 7)		
Sun					

I

<b>Late night refreshment</b> Standard days and timings (please read guidance note 8)			<b><u>Will the provision of late night refreshment take place indoors or outdoors or both – please tick</u></b> (please read guidance note 4)	Indoors	<input type="checkbox"/>
				Outdoors	<input type="checkbox"/>
				Both	<input type="checkbox"/>
Day	Start	Finish			
Mon			<b><u>Please give further details here</u></b> (please read guidance note 5)		
Tue					
Wed			<b><u>State any seasonal variations for the provision of late night refreshment</u></b> (please read guidance note 6)		
Thur					
Fri			<b><u>Non standard timings. Where you intend to use the premises for the provision of late night refreshment at different times, to those listed in the column on the left, please list</u></b> (please read guidance note 7)		
Sat					
Sun					

J

<b>Supply of alcohol</b> Standard days and timings (please read guidance note 8)			<b>Will the supply of alcohol be for consumption – please tick</b> (please read guidance note 9)	On the premises	<input type="checkbox"/>
				Off the premises	<input type="checkbox"/>
				Both	<input type="checkbox"/>
Day	Start	Finish	<b><u>State any seasonal variations for the supply of alcohol</u></b> (please read guidance note 6)		
Mon					
Tue					
Wed					
Thur					
Fri					
Sat					
Sun			<b><u>Non-standard timings. Where you intend to use the premises for the supply of alcohol at different times to those listed in the column on the left, please list</u></b> (please read guidance note 7)		

K

<p><b>Please highlight any adult entertainment or services, activities, other entertainment or matters ancillary to the use of the premises that may give rise to concern in respect of children</b> (please read guidance note 10).</p> <p>None.</p>
---

L

<b>Hours premises are open to the public</b> Standard days and timings (please read guidance note 8)			<b>State any seasonal variations</b> (please read guidance note 6)
Day	Start	Finish	
Mon	07:00	23:00	
Tue	07:00	23:00	
Wed	07:00	23:00	
Thur	07:00	23:00	
Fri	07:00	23:00	
Sat	07:00	23:00	
Sun	07:00	23:00	
			<b>Non standard timings. Where you intend the premises to be open to the public at different times from those listed in the column on the left, please list</b> (please read guidance note 7)

Please identify those conditions currently imposed on the licence which you believe could be removed as a consequence of the proposed variation you are seeking.

Please tick as appropriate

- I have enclosed the premises licence
- I have enclosed the relevant part of the premises licence

If you have not ticked one of these boxes, please fill in reasons for not including the licence or part of it below

Reasons why I have not enclosed the premises licence or relevant part of premises licence.

**M** Describe any additional steps you intend to take to promote the four licensing objectives as a result of the proposed variation:

**a) General – all four licensing objectives (b, c, d and e) (please read guidance note 11)**

All existing conditions and restrictions attached to the current Premises Licence in relation to the promotion of the licensing objectives will continue to be in effect and will apply to the provision of licensable activities as appropriate.

**b) The prevention of crime and disorder**

All existing conditions and restrictions attached to the current Premises Licence in relation to the promotion of the licensing objectives will continue to be in effect and will apply to the provision of licensable activities as appropriate.

**c) Public safety**

All existing conditions and restrictions attached to the current Premises Licence in relation to the promotion of the licensing objectives will continue to be in effect and will apply to the provision of licensable activities as appropriate.

**d) The prevention of public nuisance**

All existing conditions and restrictions attached to the current Premises Licence in relation to the promotion of the licensing objectives will continue to be in effect and will apply to the provision of licensable activities as appropriate.

**e) The protection of children from harm**

All existing conditions and restrictions attached to the current Premises Licence in relation to the promotion of the licensing objectives will continue to be in effect and will apply to the provision of licensable activities as appropriate.



Checklist:

**Please tick to indicate agreement**

- I have made or enclosed payment of the fee; or X
- I have not made or enclosed payment of the fee because this application has been made in relation to the introduction of the late night levy. X
- I have sent copies of this application and the plan to responsible authorities and others where applicable. **ONLINE APPLICATION LA TO SEND**
- I understand that I must now advertise my application. X
- I have enclosed the premises licence or relevant part of it or explanation. X
- I understand that if I do not comply with the above requirements my application will be rejected. X

**IT IS AN OFFENCE, UNDER SECTION 158 OF THE LICENSING ACT 2003, TO MAKE A FALSE STATEMENT IN OR IN CONNECTION WITH THIS APPLICATION. THOSE WHO MAKE A FALSE STATEMENT MAY BE LIABLE ON SUMMARY CONVICTION TO A FINE OF ANY AMOUNT.**

**Part 5 – Signatures** (please read guidance note 12)

**Signature of applicant (the current premises licence holder) or applicant’s solicitor or other duly authorised agent** (please read guidance note 13). **If signing on behalf of the applicant, please state in what capacity.**

Signature	<i>Keystone Law</i>
Date	11 June 2024
Capacity	Keystone Law, Solicitors for and on behalf of the applicant

**Where the premises licence is jointly held, signature of 2nd applicant (the current premises licence holder) or 2nd applicant’s solicitor or other authorised agent** (please read guidance note 14). **If signing on behalf of the applicant, please state in what capacity.**

Signature	
Date	
Capacity	

<b>Contact name (where not previously given) and address for correspondence associated with this application</b> (please read guidance note 15) Marilyn Gayle Keystone Law 48 Chancery Lane			
<b>Post town</b>	London	<b>Post code</b>	WC2A 1JF
<b>Telephone number (if any)</b>	07423 640 206		
<b>If you would prefer us to correspond with you by e-mail, your e-mail address (optional)</b> Marilyn.gayle@keystonelaw.co.uk			

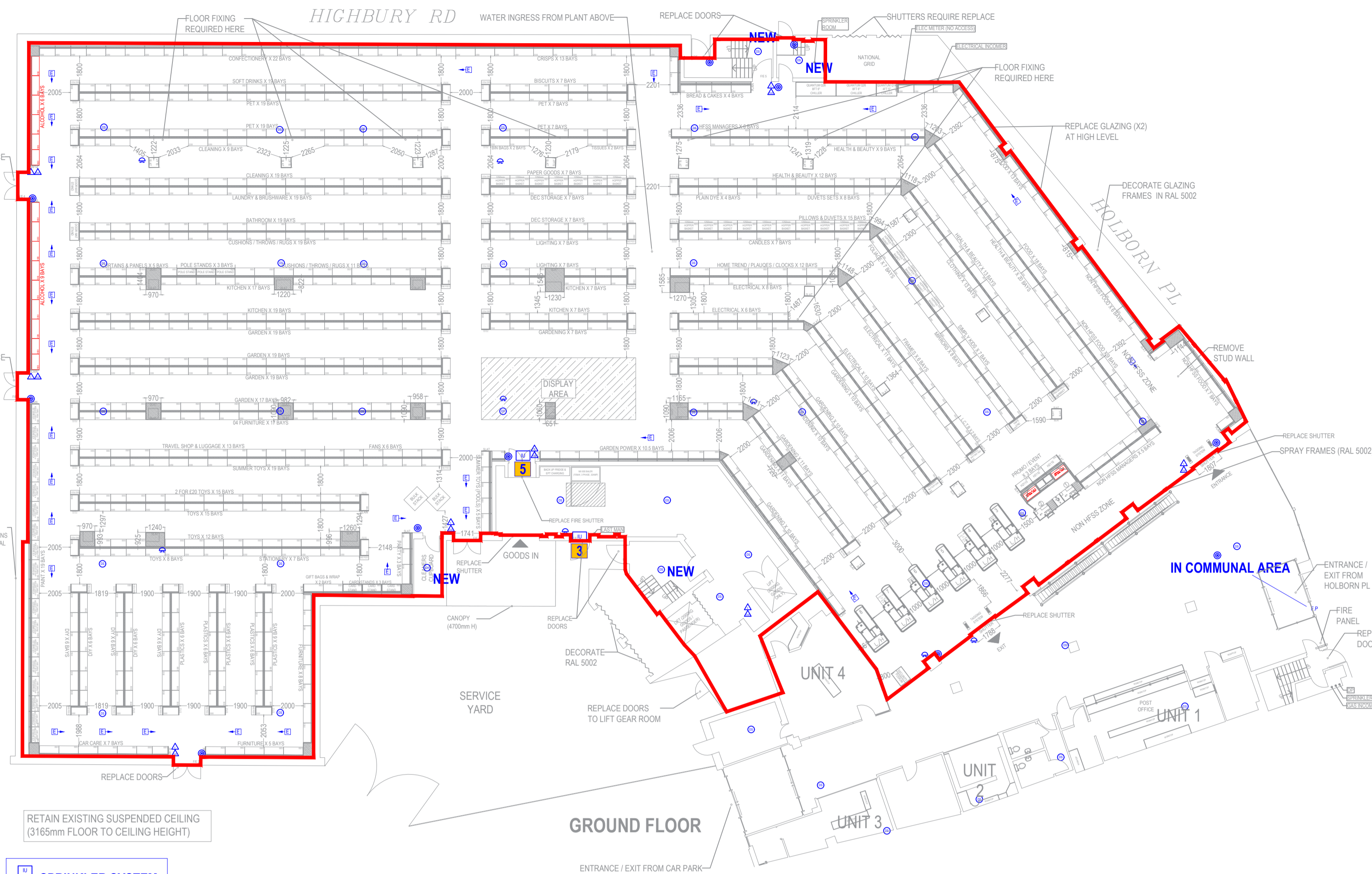

Licence for sale of alcohol to cover whole of trading area to allow for flexibility of display - Alcohol display will be less than 10% of trading area.

AREA APPROVED FOR THE SALE/STORAGE OF ALCOHOL

THE FOLLOWING SYSTEM DESIGN SPECIFICATION IS FOR THE INSTALLATION OF A FIRE DETECTION AND FIRE ALARM SYSTEM AT THE ABOVE PREMISES. THE FIRE DETECTION AND FIRE ALARM SYSTEM WILL BE DESIGNED, INSTALLED AND COMMISSIONED IN ACCORDANCE WITH BS5839-1: 2017. (A FULL BAFE CERTIFICATE SHALL BE ISSUED WHEN APPROPRIATE).

DESIGN STATEMENT

THE QUOTATION/ SPECIFICATION FOR THE EQUIPMENT AND INSTALLATION ARE PER THE INFORMATION PROVIDED BY THE CLIENT AT THE TIME OF THE SURVEY TO CATCHPOINT UK LTD. THE

SYSTEM WILL BE CONTROLLED BY A CONVENTIONAL CONTROL PANEL, MANUAL CALL POINTS, AUTOMATIC DETECTION, INTERNAL SOUNDERS AND VISUAL ALARM DEVICES.

IT SHALL BE THE CLIENTS RESPONSIBILITY TO VERIFY THAT THE FIRE ALARM PROPOSED WITHIN THIS SPECIFICATION MEETS WITH THE REQUIREMENTS OF ANY INTERESTED PARTY, I.E. INSURERS, BUILDING CONTROL OFFICERS, FIRE AND RESCUE SERVICES ETC.

THE SYSTEM IS DESIGNED FOR A CATEGORY L1 TYPE FIRE DETECTION AND FIRE ALARM SYSTEM

FIRE CABLE ALL CABLING FOR THE FIRE ALARM SYSTEM WILL BE 2 CORE 1.5MM STANDARD RATED FIRE CABLE. VARIATIONS FROM DESIGN

PLEASE REFER TO THE VARIATIONS SHEET. STANDARD BATTERY PERIOD THE SYSTEM SHALL BE PROVIDED WITH BATTERIES TO POWER THE SYSTEM FOR A MINIMUM OF 24 HOURS IN STANDBY AND ADDITIONAL 30 MINUTES IN ALARM.

DESIGN DRAWING THE SYSTEM SHALL BE INSTALLED IN ACCORDANCE WITH THE ATTACHED

DRAWING NUMBER: TBC REVISION: 0 DATED: 01/03/2024

CONTROL EQUIPMENT

A 230 VOLT MAIN SUPPLY FOR THE FIRE ALARM IS TO BE SUPPLIED BY OTHERS, IN SOFT SKIN STANDARD FIRE CABLE. LIST OF EQUIPMENT

- 1 X FIRE PANEL
- 2 X BATTERIES
- 5 X INTERFACES
- 68 X SMOKE DETECTORS
- 2 X HEAT DETECTOR
- 16 X MANUAL CALL POINTS
- 16 X REMOTE SOUNDERS
- 3 X VADS

- NOTES:**
- 1.) FIRE ALARM SYSTEM COVER B&M STORE + MAIN MALL WHICH INCORPORATES ADJACENT UNITS + POST OFFICE
  - 2.) ADDITIONAL DEVICES REQUIRED IN AREAS (AS PER PLAN)
  - 3.) 2X ACCESS CONTROL DOORS TO BE INTERFACED TO FIRE ALARM
  - 4.) FIRE SHUTTER TO BE INTERFACED TO FIRE ALARM
  - 5.) MANUAL CALL POINTS + SMOKE DETECTORS TO BE REPLACED ON SALES FLOOR BACK OF HOUSE DETECTION TO REMAIN
  - 6.) NO VOID DETECTION ABOVE SALES FLOOR CEILING + FIRE FLOOR OFFICES VARIATION REQUIRED

FIRE DETAIL KEY	
F.P	CONVENTIONAL FIRE PANEL
F.P.R	FIRE PANEL REPEATER
E	DIRECTIONAL FIRE EXIT
△	ILLUMINATED FIRE ESCAPE SIGN
⊙	EMERGENCY LIGHTING
⊙	MANUAL CALL POINT
⊙	EXTERNAL MANUAL CALL POINT
⊙	REMOTE SOUNDER
⊙	VAD
⊙	CONVENTIONAL SOUNDER BEACON
⊙	DETECTOR HEAT
⊙	DETECTOR HEAT WITH SOUNDER BASE
⊙	DETECTOR SMOKE
⊙	DETECTOR SMOKE IN VOID WITH LED INDICATOR
⊙	DETECTOR SMOKE IN ROOF
⊙	DETECTOR SMOKE WITH SOUNDER BASE
⊙	DETECTOR SMOKE WITH SOUNDER BEACON BASE
⊙	SOUNDER / HEAT
⊙	SPRINKLER HEAD
△	FOAM FIRE EXTINGUISHER
△	WATER FIRE EXTINGUISHER
△	POWDER FIRE EXTINGUISHER
△	CO2 FIRE EXTINGUISHER
⊙	BEAM TO BEAM DETECTOR
⊙	FIRE BLANKET
⊙	BEAM IN VOID
⊙	INDICATOR
IU	INTERFACE UNIT
1A0	INTERFACE AUTOMATIC DOORS
1S5	INTERFACE SPRINKLER SYSTEM
▶	EXISTING BEAM
FOAM FIRE EXTINGUISHERS RATED AT 21A/14B	

No.	Interface list:	Input / Output
1	Sprinkler System	Input
2	Monitoring (In Cash Office)	Output
3	Access Control 1	Output
4	Access Control 2	Output
5	Fire Shutter	Output

**PLEASE NOTE:**  
All auto doors Interfaces must be no more than 1M away from the door

FIRE EXIT PROVISIONS - RETAIL UNIT		
EXIT WIDTHS / PERSONS	Sales Areas	
	Ground Floor	First Floor
MAX. SINGLE DIRECTIONAL TRAVEL DISTANCE	18 m	
MAX. TWO-DIRECTIONAL TRAVEL DISTANCE	45 m	
OCCUPANCY	2 m2/PERSONS	
COMPARTMENT AREA (m2)	2,462.6	0.0
OCCUPANCY (PERSONS)	1,232	0
REQUIRED OPENING (mm)	6,160	0
(TOTAL PEOPLE X 5mm PER PERSON EXIT WIDTH)		
FIRE EXIT WIDTHS (mm)		
MAIN ENTRANCE/EXIT	1,807	0
MAIN EXIT (IF APPLICABLE)	1,788	0
GRP W/H DOORS (IF APPLICABLE)	0	0
GARDEN CENTRE DOORS (IF APPLICABLE)	0	0
F/E 1	1,741	0
F/E 2	1,759	0
F/E 3	1,753	0
F/E 4	1,739	0
F/E 5	1,219	0
TOTAL CLEAR OPENING FROM COMPARTMENT FLOOR AREA (mm)	11,806	0
EXCLUDE LARGEST OPENING (mm)	1,807	0
FINAL CLEAR OPENING (mm)	9,999	0

<p>DO NOT SCALE - USE FIGURED DIMENSIONS ONLY. ALL LAYOUTS MUST BE VERIFIED ON SITE AND ANY DISCREPANCIES NOTIFIED IMMEDIATELY TO THE SHOPFITTER. ALL DIMENSIONAL CHECKS MUST BE MADE PRIOR TO INSTALLATION.</p>	<p><b>MAIN STREET (BULWELL)</b></p> <p>SITE ADDRESS: (FORMER WILKO) 36 / 48 MAIN ST BULWELL NOTTINGHAM NG6 8EW</p>	<p>TITLE: PROPOSED FIRE LAYOUT (GROUND &amp; FIRST FLOOR)</p> <p>CLIENT: B&amp;M RETAIL LTD.</p>	<p>GROUND FLOOR: 2,462.6 sqm</p> <p>UPPER FLOOR: 0.0 sqm</p>	<p>SALES AREA: 26,507 sqft</p> <p>WAREHOUSE: 105.3 sqm</p> <p>AMENITIES: 47.6 sqm</p> <p>GARDEN CENTRE (INC. GREENHOUSE): 0.0 sqm</p> <p>TOTAL GROSS (ALL FLOORS): 4,058.2 sqm</p>	<p>STANDARD BAY FOOTAGE: 154.5</p> <p>WALL BAYS: 808</p> <p>GONDOLA BAYS: 962.5</p> <p>PROMO END BAYS: 54</p> <p>TOTAL BAYS (INCLUDING END BAYS): 989.5</p> <p>TOTAL GROSS (INCLUDING END BAYS): 1047.5</p>	<p>SHELVING PROFILES: H2610 D470</p> <p>STANDARD WALL BAYS: H2610 D470</p> <p>STANDARD PAINT BAYS: H2610 D670</p> <p>STANDARD GONDOLA: H1810 D470</p> <p>STANDARD LOW LEVEL: H1810 D470</p> <p>EPU: PROMO ENDS: H1810 D470</p> <p>ALL TIMBER PANELS, BEAMS, CORNICES &amp; COLUMN GLAZING TO BE INSTALLED AS DETAILLED ON DRAWING.</p>
		<p>LAYOUT: BM</p> <p>FLOOR: AD</p> <p>FLOORS: 2</p> <p>DRG NO: BM-859-0-006</p> <p>SCALE: 1:200@A1</p> <p>DATE: 11.06.24</p> <p>REVISION: A</p>	<p>REV: 11.06.24</p> <p>DESCRIPTION: FIRE EXIT OMITTED (GROUND FLOOR)</p>			